





IVR 72 - Tre vie L



 Valvola a sfera a Tre vie deviatrice in ottone nichelato, sfera forata a L a passaggio standard, attacchi F/F/F, con leva piatta in acciaio rosso

 3-way diverter ball valve with standard bore - type L
Threaded ends F/F/F

 3-Wege Ableitventil mit Standarddurchgang mit L-Bohrung - IG/IG/IG

 Vanne déviatrice à boisseau sphérique à 3 voies avec passage normal, percée en L - fixations F/F/F

 Трехходовой распределительный кран из латуни, никелированный, с редуцированным проходом, сфера с "L" образным отверстием, соединение В/В/В, плоская ручка из нержавеющей стали красного цвета.

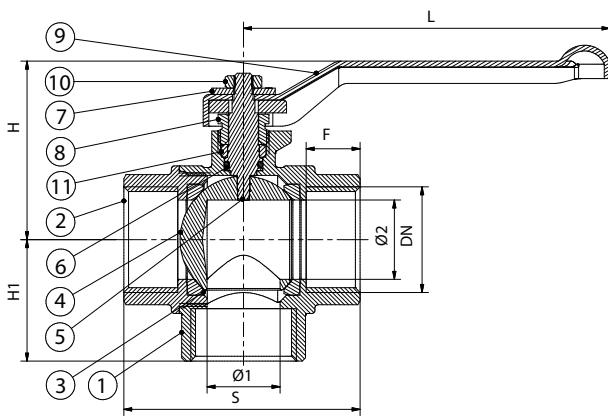
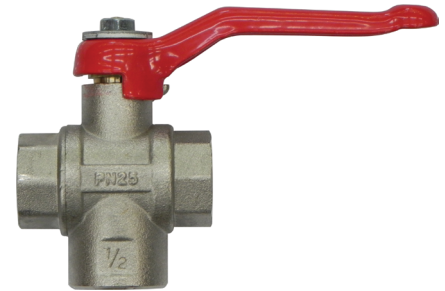

N	DENOMINAZIONE PART NAME	MATERIALE MATERIAL	TRATTAMENTO TREATMENT
1	Corpo - Body	Ottone - Brass CW617N - UNI EN 12165	Nichelato - Nickel plated
2	Manicotto Body end	Ottone - Brass CW617N - UNI EN 12165	Nichelato - Nickel plated
3	Seggio - Seat	PTFE	
4	Sfera - Ball	Ottone - Brass CW617N - UNI EN 12165	Cromata - Chrome plated
5	Asta - Stem	Ottone - Brass CW614N - UNI EN 12164	
6	O-Ring	FKM	
7	Indicatore - Seal	Alluminio - Aluminium	
8	Premistoppa Packing nut	Ottone - Brass CW614N - UNI EN 12164	
9	Maniglia - Handle	Acciaio - Steel	Verniciato - Painted
10	Dado - Nut	Acciaio - Steel	Zincato - Zinc plated
11	* Rondella - Seal	PTFE	

* Non presente nella versione 3" (tenuta asta con 2 o-ring)

* Not present in version 3" (stem seal with 2 o-rings)

DIMENSIONI - DIMENSIONS (mm)

Size	S	F	Ø1	Ø2	H	H1	L
1/4"	53	14	10	10	48	31	92
3/8"	53	14	10	10	48	31	92
1/2"	55	14	12	12	48	31	92
3/4"	66	16	18	20	50	34	92
1"	74	17	23	25	55	38	115
1 1/4"	85	18	30	32	68	46	150
1 1/2"	97	19	37	39	73	53	150
2"	109	21	46	48	79	62	150
3"	177	25	80	80	129	115	240

