





# INOX - IVR 664



-  Valvola a sfera in due pezzi in acciaio inox AISI 316  
Flangia ISO 5211 e attacchi flangiati PN 16
-  AISI 316 stainless steel two-piece ball valve  
Flanged ends PN16 - ISO 5211 mounting plate
-  Zweiteiliger Kugelhahn aus Edelstahl AISI 316  
Flanschplatte ISO 5211 und Flanschanschlüsse PN 16
-  Vanne à boisseau sphérique en deux pièces en acier inox AISI 316  
Platine ISO 5211 et fixations brides PN 16
-  Двухсоставной полнопроходной шаровой кран из нержавеющей стали AISI 316 - фланец ISO 5211 - Фланцевое соединение PN 16

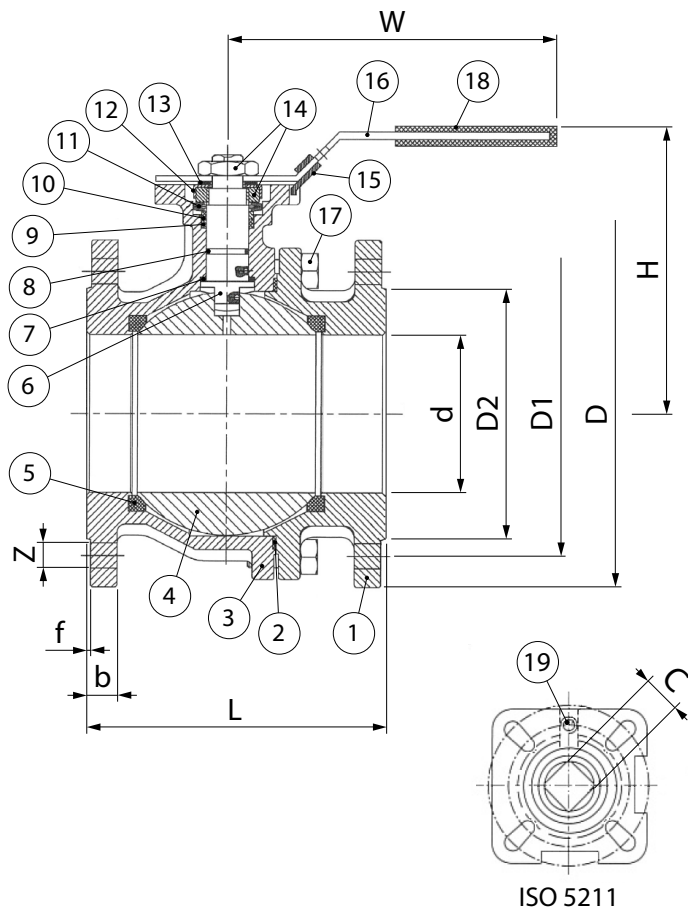

| ITEM | PART NAME                             | MATERIAL     | QTY   |
|------|---------------------------------------|--------------|-------|
| 1    | Manicotto - Body End                  | CF8M         | 1     |
| 2    | Guarnizione Corpo - Body Gasket       | PTFE         | 1     |
| 3    | Corpo - Body                          | CF8M         | 1     |
| 4    | Sfera - Ball                          | SS316        | 1     |
| 5    | Seggio Sfera - Ball Seat              | R-PTFE (15%) | 2     |
| 6    | Asta - Stem                           | SS316        | 1     |
| 7    | Rondella - Thrust Washer              | PTFE         | 1     |
| 8    | O-Ring                                | VITON        | 1     |
| 9    | Guarnizione Asta - Stem Packing       | PTFE         | 1     |
| 10   | Anello Asta - Stem Ring               | SS316        | 1     |
| 11   | Rondella - Washer                     | SS301        | 2     |
| 12   | Dado di fermo - Nut Stopper           | SS304        | 1     |
| 13   | Rondella - Plate Washer               | SS304        | 1     |
| 14   | Dado - Nut                            | SS304        | 2     |
| 15   | Dispositivo di blocco - Lock Device   | SS304        | 1     |
| 16   | Leva - Handle                         | SS304        | 1     |
| 17   | Bullone - Bolt                        | SS304        | 4/6/8 |
| 18   | Rivestimento Plastico - Plastic Cover | PLASTIC      | 1     |
| 19   | Perno di fermo - Stop Pin             | SS304        | 1     |

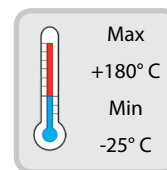

Estremità flangiate  
UNI EN 1092  
Flanged ends  
UNI EN 1092

## DIMENSIONI - DIMENSIONS (mm)

| Size  | d   | L   | D   | D1  | D2  | b  | f | H   | W   | C  | ISO 5211 | Z     | N/m |
|-------|-----|-----|-----|-----|-----|----|---|-----|-----|----|----------|-------|-----|
| DN15  | 15  | 115 | 95  | 65  | 45  | 16 | 2 | 82  | 117 | 9  | F03/F04  | 4xØ14 | 5   |
| DN20  | 20  | 120 | 105 | 75  | 58  | 18 | 2 | 87  | 117 | 9  | F03/F04  | 4xØ14 | 8   |
| DN25  | 25  | 125 | 115 | 85  | 68  | 18 | 2 | 90  | 164 | 11 | F04/F05  | 4xØ14 | 10  |
| DN32  | 32  | 130 | 140 | 100 | 78  | 18 | 2 | 100 | 164 | 11 | F04/F05  | 4xØ18 | 14  |
| DN40  | 40  | 140 | 150 | 110 | 88  | 18 | 3 | 116 | 203 | 14 | F05/F07  | 4xØ18 | 18  |
| DN50  | 50  | 150 | 165 | 125 | 102 | 20 | 3 | 125 | 203 | 14 | F05/F07  | 4xØ18 | 25  |
| DN65  | 65  | 170 | 185 | 145 | 122 | 18 | 3 | 164 | 255 | 17 | F07/F10  | 4xØ18 | 48  |
| DN80  | 80  | 180 | 200 | 160 | 138 | 20 | 3 | 174 | 255 | 17 | F07/F10  | 8xØ18 | 75  |
| DN100 | 100 | 190 | 220 | 180 | 158 | 20 | 3 | 200 | 302 | 17 | F07/F10  | 8xØ18 | 110 |

Size   
DN15-DN100 16 bar

ASTA ANTISCOPPIO  
ANTI BLOW-OUT STEM

Tutte le caratteristiche tecniche dei prodotti sono soggette a modifiche senza preavviso - All product's technical specifications are subject to modification without prior notice

